

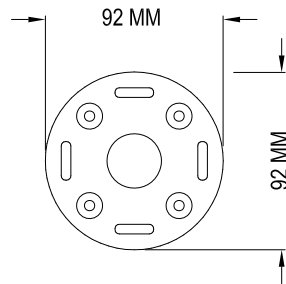

STEEL PAVER SUPPORT SPECIFICATION

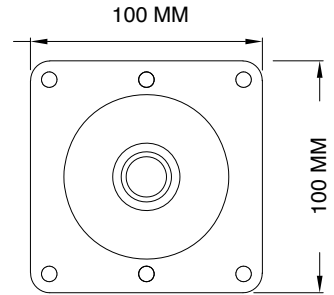

TOP VIEW



TOP VIEW

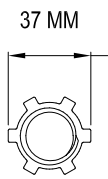

TOP VIEW

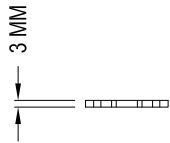

SIDE VIEW
TIGHTENING NUT

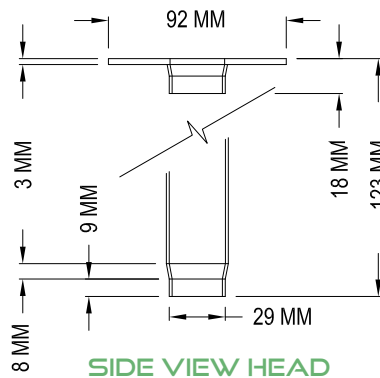

SIDE VIEW HEAD

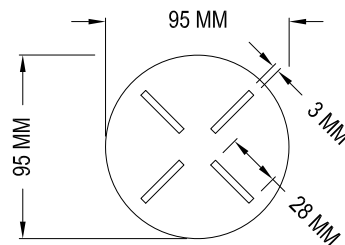

TOP VIEW

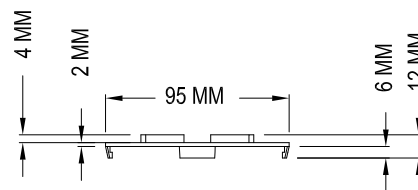

SIDE VIEW GASKET

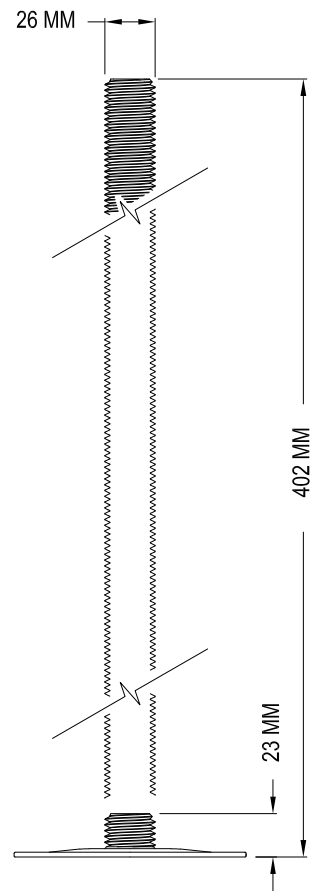

SIDE VIEW BASE

SPECIFICATIONS:

MATERIAL: MILD STEEL

FINISH: ZINC-NICKEL ANTI-CORROSION

BASE SIZE: 100MM X 100MM

LOADING: 9500KG (9.5KN)

FIRE RATING: CLASS A1/A2

GENERAL NOTES:

1. INSTALLATION TO BE COMPLETED IN ACCORDANCE WITH RHINO BY PAVEZZI (PAVEZZI COMPOSITES) SPECIFICATIONS.
2. DO NOT SCALE DRAWING.
3. THIS DRAWING IS INTENDED FOR USE BY ARCHITECTS, ENGINEERS, CONTRACTORS, CONSULTANTS AND DESIGN PROFESSIONALS FOR PLANNING PURPOSES ONLY AND SHOULD NOT BE USED FOR CONSTRUCTION.
4. ALL INFORMATION CONTAINED HEREIN WAS CURRENT AT THE TIME OF DEVELOPMENT BUT MUST BE REVIEWED AND APPROVED BY RHINO BY PAVEZZI (PAVEZZI COMPOSITES) TO BE CONSIDERED ACCURATE.



NON-COMBUSTIBLE STEEL PAVER SUPPORTS

ADJUSTABLE HEIGHT STEEL PAVER SUPPORTS

REVISION DATE 25/03/2025